

# GN 598 | Revolving handles

Steel

METRIC



## MATERIAL

Steel, epoxy resin coating, RAL 9005 black colour, matte finish.

## STANDARD EXECUTION

Zinc-plated steel pin, hexagon socket at threaded end.



# GN 798 | Revolving handles

Aluminium

METRIC



## MATERIAL

Turned and mirror polished aluminium.

## STANDARD EXECUTION

Zinc-plated steel pin, hexagon socket at threaded end.

## SPECIAL EXECUTIONS ON REQUEST

Shank with different threadings.



Conversion Table  
1 mm = 0,039 inch

d1	
mm	inch
16	0.63
18	0.71
21	0.83
22	0.87
23	0.91
24	0.94
25	0.98
26	1.02
28	1.10
31	1.21

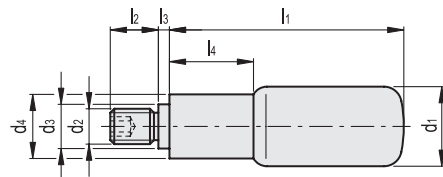
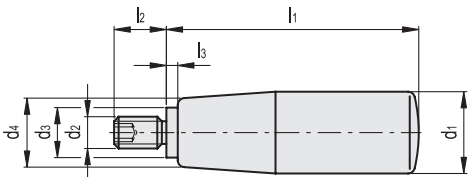

METRIC

Code	Description	d1	d2	d3	d4	l1	l2	l3	⚖️
GN.28091	GN 598-ST-21-M6	21	M6	10	17	52.5	13	2.5	120
GN.28092	GN 598-ST-21-M8	21	M8	10	17	52.5	13	2.5	122
GN.28101	GN 598-ST-23-M8	23	M8	13	19	67.5	14	2.5	188
GN.28102	GN 598-ST-23-M10	23	M10	13	19	67.5	14	2.5	190
GN.28111	GN 598-ST-26-M8	26	M8	13	21	82.5	16	2.5	295
GN.28112	GN 598-ST-26-M10	26	M10	13	21	82.5	16	2.5	298
GN.28121	GN 598-ST-28-M10	28	M10	13	22	92.5	16	2.5	390
GN.28131	GN 598-ST-31-M12	31	M12	14	25	104.5	20	2.5	563

METRIC

Code	Description	d1	d2	d3	d4	l1	l2	l3	l4	⚖️
GN.11191	GN 798-AL-16-M6	16	M6	10	13	41.5	12	2.5	15	38
GN.11195	GN 798-AL-18-M6	18	M6	10	14.5	56	13	2.5	19	50
GN.11196	GN 798-AL-18-M8	18	M8	10	14.5	56	13	2.5	19	53
GN.11200	GN 798-AL-22-M6	22	M6	14	18.5	59	14	2.5	21	60
GN.11201	GN 798-AL-22-M8	22	M8	14	18.5	59	14	2.5	21	60
GN.11202	GN 798-AL-22-M10	22	M10	14	18.5	59	14	2.5	21	63
GN.11204	GN 798-AL-24-M8	24	M8	14	18.5	74	16	2.5	27	72
GN.11205	GN 798-AL-24-M10	24	M10	14	18.5	74	16	2.5	27	75
GN.11211	GN 798-AL-25-M10	25	M10	16	20	84	16	2.5	30	90

- 1
- 2
- 3
- 4
- 5
- 6
- 7
- 8
- 9
- 10
- 11
- 12
- 13
- 14
- 15
- 16
- 17
- 18

Fixed & Revolving handles